

Project _____

Type _____

Notes _____



SECTION VIEWS

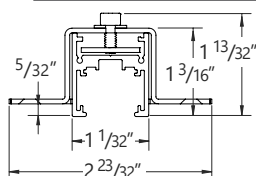

DS drywall spackle bracket shown

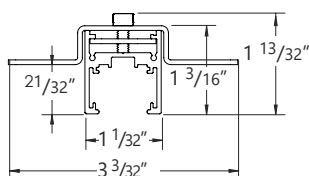

DB05 slip through bracket 1/2" drywall shown

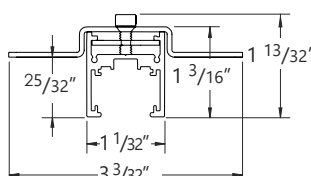

DB075 slip through bracket 5/8" drywall shown

CORNERS

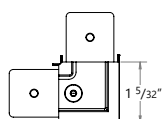

L-hub shown

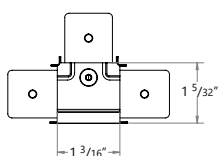

T-hub shown

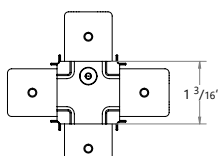

X-hub shown

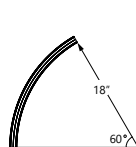

CT60 18" Radius
60 degree curve shown

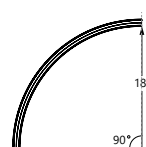

CT90 18" Radius
90 degree curve shown

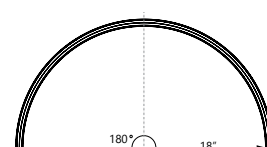

CT180 18" Radius
180 degree curve shown

Ordering Guide

PRODUCT ID	LENGTH AND PATTERNS (Select one)	CORNER QTY (OPT.) Required for FF(L) free form pattern	FINISH	WATTAGE	VOLTAGE
THDR Thread recessed	L 2ft-8ft stand alone linear S(L) system run (total length) SQ(L)* square shape (length) R(LxL)* rectangular shape (length) U(LxLxL)* U shape (length) L(LxL)* L shape (length) T(LxLxL)* T shape (length) X(LxLxLxL)* X shape (length) FF(L) free form total pattern length	L(#) L hub (qty.) T(#) T hub (qty.) X(#) X hub (qty.) CT60(#) 60° curved track (18" radius) - qty. CT90(#) 90° curved track (18" radius) - qty. CT180(#) 180° curved track (18" radius) - qty. CTC(degree, radius, qty) Curved track custom (specify degree, radius and quantity)	W white BLK black	60 60 watt 100 100 watt	120 120V 277 277V UNV universal 347 347V
* See page 2 for information on how to specify.					

DRIVER	CIRCUITS	MOUNTING	REMOTE BOX	OTHER (OPT.)
DPCV remote 48V driver, dimming 0-10V through two contacts DALIDT6CV remote 48V driver, DALI dimming through two contacts	1 1 circuit	DS drywall spackle bracket DB05 slip through bracket 1/2" drywall DB075 slip through bracket 5/8" drywall	RBS standard remote driver box	BL field cuttable blank track cover*
* Total ordered track length will be provided. Field cuttable per desired length sections.				

● CONSTRUCTION

Housing	Extruded aluminum (0.070" nominal)
Four conductor track	Four conductors two on either side

● ELECTRICAL

Input Voltage	120V, 277V, 347V
DP driver (DPCV)	THREAD remote 48V driver 100W max with current limiter in the driver. 0-10V dimming through two contacts on track with current limitation on the driver.
DALI driver (DALIDT6CV)	THREAD remote 48V driver 100W max with current limiter in the driver. DALI 2.0 dimming through two contacts on track with current limitation on the driver.

i Incorporating these components may have limitations or affect the length of the luminaire, please contact factory for more details.

Driver is rated at 60W or 100W. When selecting luminaires to power from track, please make sure that the sum of their individual ratings does not exceed 60W or 100W. For track compatible luminaires and their consumption requirements, please refer to their respective spec sheets (see example image below).

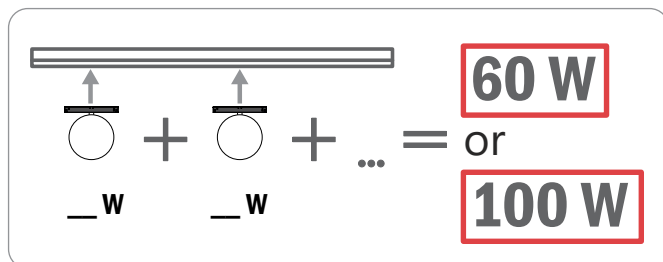

EX: Orb - 22 W per unit
Thread track - 100 W Maximum
4 Orb fixtures at 22W each =88W

One segment of track can house 4 units of Orb (5 units exceed maximum of 100 W).

● WEIGHT

Estimated insert weight per linear foot 0.75lbs/ft = 0.34kg/ft

● FINISH

Powder coated black or white finish..

● APPROVALS

Certified to cULus standards. 
 Track certified under UL1598. All track adapters certified under UL2108.

● WARRANTY

Limited 5-year warranty is available. Warranty is valid provided luminaires are installed and used according to specifications. For full terms and conditions, please consult warranty section at axislighting.com.

● HUBS

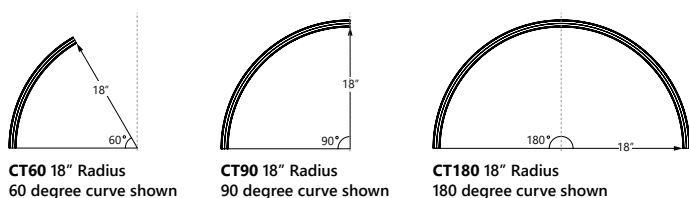
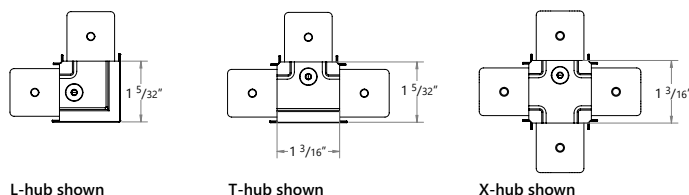

How to Specify 90 degree Corners and Patterns

Example: THDS-R(9'x5')-BLK-100-UNV-DALIDT6CV-1-S-RBS-BL

Defining R - Rectangular shape

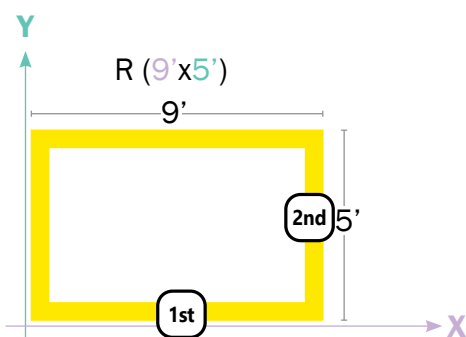

Defining L shape

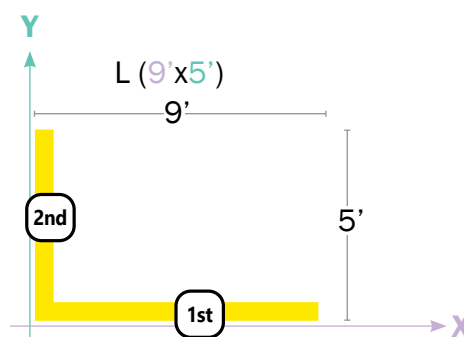

Note: The first number will always define the width, the second - the length.

Defining U shape

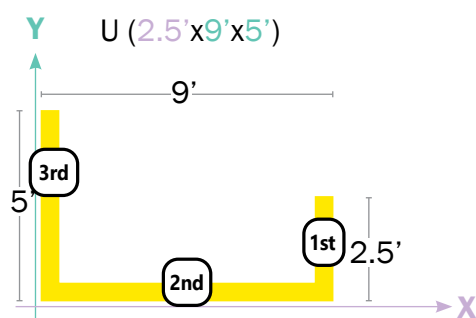

Note: The first number will always define the right arm length, the second - the width, and the third - the left arm length.

Defining T shape

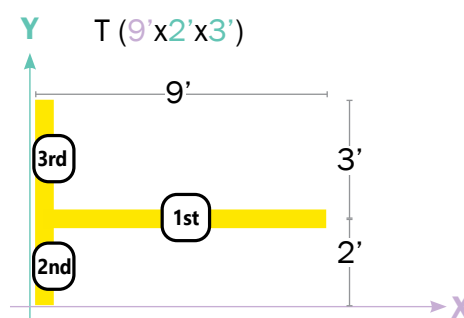

Note: The first number will always define the width, the second - the bottom arm length, and the third - the top arm length.

Defining S - Square shape

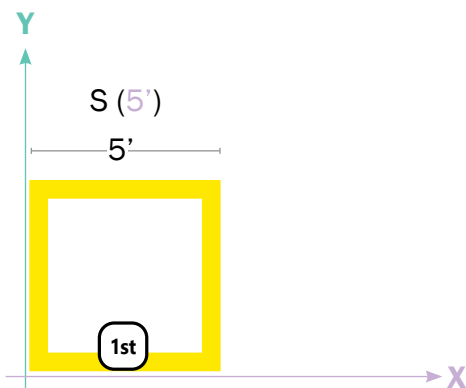

Note: The number will define the width. (All sides are the same length).

Defining X shape

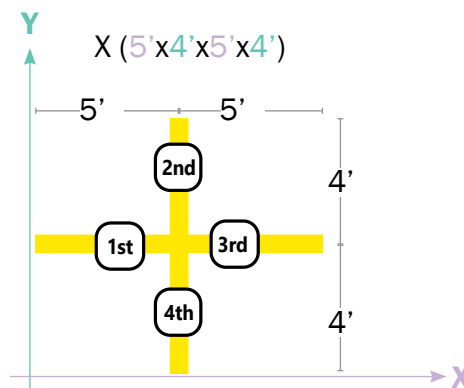

Note: The first number will define length of the left arm, the second - the arm length to the right from the first, and so on until the 4th arm.



A large grid of squares, intended for drawing corner patterns. The grid consists of 30 columns and 30 rows of squares, providing a space for technical drawings.