

Sketch 2

PERIMETER - IP54

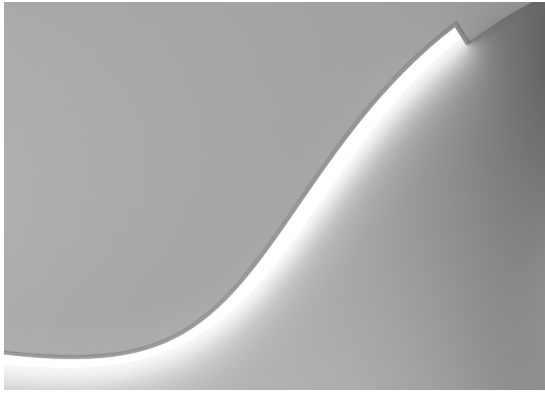

Project _____
 Type _____
 Notes _____

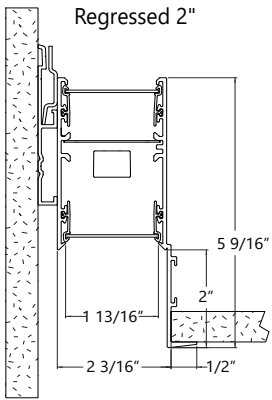

Ordering Guide

SK2PRS-FF(101010)*-AL(9'2")-1000-90-35-SO-RG2-W-120-DP-1-DF

*Project reference number provided by Axis

| SK2PRS | | PATTERNS AND FORMS | | TOTAL LENGTH, CORNER QTY. | | LUMENS/FT | | CRI |
|------------|---------------------|---|--|---------------------------|--|--|-------------------------|-------------------------|
| PRODUCT ID | | FF(#) | free form pattern (project reference #)* | AL('XX") | specify total linear length in feet (2 ft minimum) | 300 | 300 lm/ft - min | 90 |
| SK2PRS | Sketch 2 Perimeter | ARC(R, Deg.) | arc (radius, degrees) | +CRN(#) | sharp corner (qty.) | 1100 | 1100 lm/ft - max | high efficacy 90 CRI |
| | Recessed | LIN(L) | linear (length) | | | 900 | 900 lm/ft - max for RG2 | |
| | Sealed - IP54 rated | | | | | | | |
| | | *Please provide pattern drawing, and specify project reference number. Factory is available for assistance. Regular lit corners (min 45 degrees) available. | | | | Outputs between listed are available. Consult factory for outputs outside of the listed range. | | |

| COLOUR TEMP. | | SHIELDING | SHIELDING POSITION | FINISH | VOLTAGE | | DRIVER | | |
|--------------|-----------------------------|-----------|--------------------|--------|---------------------|---|---------------|---|--|
| 27 | 2700 K | SO | spotless lens | FL | flush spotless lens | 120 | 120V | DP | dimming (0-10V) 1% - integral |
| 35 | 3500 K | | | | | 277 | 277V | DALI2 | integral driver DALI 2.0 Type 6 - integral |
| 30 | 3000 K | | | | | 347 | 347V* | LT(#) | Lutron - remote* |
| 40 | 4000 K | | | | | UNV | universal | O(#) | other - remote** |
| TW2750 | 2700-5000 K - Tunable White | | | | | DC | low voltage** | O(DMX) | other (Digital Multiplex)- remote** |
| TW2765 | 2700-6500 K - Tunable White | | | | TW(#) | tunable white drivers - remote* | | | |
| | | | | | | | | POE(#) | POE drivers - remote* |
| | | | | | | * Remote only. ** Only available with POE drivers. | | * Specify system; see page 2. **Please consult factory; see page 2 | |

| CIRCUITS | | MOUNTING | | REMOTE BATTERY (OPT.) | OTHER (OPT.) | | CUSTOM (OPT.) | | |
|---------------------------------------|--------------------------------|----------|-----------------|-----------------------|--|----|---------------------|---|--------|
| 1 | 1 circuit | DF | drywall flange | BR(#) | battery pack remote | FW | flex whip (6' std)* | C | custom |
| 2 | 2 circuits | DS | drywall spackle | | | | | | |
| +E(#) | emergency circuit * | | | | | | | | |
| +GTD(#) | generator transfer device * ** | | | | | | | | |
| * Specify quantity ** Remote only. | | | | Requires 120V or 277V | * Other lengths available; please consult factory. | | Please specify | | |

● CONSTRUCTION

| | |
|--------------------------------|------------------------------------|
| Housing | Extruded aluminum (0.075" nominal) |
| Interior reflectors | Sheet aluminum (16 gauge) |
| Mounting brkts. | 14GA Galvanized Steel |
| Joining brackets. | Die cast aluminum (0.10" nominal) |
| Incap & Cross Brkt. | Die cast aluminum (0.10" nominal) |

● SHEILDING

| | |
|----------------------|------------------------|
| Spotless Lens | Acrylic (0.06" thick). |
|----------------------|------------------------|

● FINISH

Highly reflective, white powder coat finish paint for high efficiency. Matte texture to diffuse glare and lamp image on the surface within the optical chamber exterior. Custom finishes are also available.

● WEIGHT

Approximately 1.75lbs/ft = 0.8kg/ft (linear)

● ELECTRICAL

| | |
|--|--|
| DP driver | integral DP driver. 0-10V 1% dimming standard. |
| DALI2 driver | integral DALI driver. DALI Type 6 standard. DALI 2.0 D4i certified driver. |
| Lutron driver* (Remote) | LDE1 - EcoSystem H-Series (1%) |
| Other drivers* (Remote) | DMX - Digital Multiplex Xitanium SR - For wireless sensor *Consult factory |
| Tunable White TW drivers* (Remote) | DALIDT6 - DALI Type 6 (Two DALI Addresses) DALIDT8 - DALI Type 8 (One DALI Address) DPTW - two channel 0-10V dimming: one channel for brightness, one channel for CCT. LDTW - Lutron DALI Type 8 (One DALI adress) Tunable White series |
| Power over Ethernet POE drivers* (consult factory for more information) UL2108 certified for remote driver | MOLEX IGOR SMARTENGINE O - Other (Consult factory) |
| Emergency* | Remote emergency battery pack or emergency circuit optional. *Consult factory |
| Input Voltage | 120V, 277V, 347V, UNV, DC. |

i Incorporating these components may have limitations or effect the length of the luminaire, please contact factory for more details.

● LED SYSTEM

| | |
|----------------------------|---|
| CRI | Minimum high efficacy 90 color rendering index. |
| CCT Single Color | Choice of 2700K, 3000K, 3500K and 4000K color temperature with a great color consistency (within 3-step MacAdam ellipse). Both within fixture and fixture to fixture. |
| LED life | Minimum 50,000h with 85% of lumen maintenance in 25°C ambient temperature, in compliance with IES LM-80 testing measurements. |
| CCT Axitune Systems | Consult Axitune technical sheet for more information on color technology. |
| Thermal Management | Aluminum housing acting as the heat sink to maximize life. |
| Environment | Outdoor under canopy, indoor healthcare and wipe down IP54 rated |

● APPROVALS

Certified to CSA standards 
Meets NYC requirements
Suitable for outdoor under canopy, indoor healthcare and wipe down IP54 rated

● WARRANTY

Axis Lighting will warrant defective LEDs, boards, and drivers for 5 years from date of purchase. Warranty is valid if luminaire is installed and used according to specifications. If defective, Axis will send replacement boards or drivers at no cost along with detailed replacement instructions and instructions on how to return defective components to Axis.

● SECTION VIEWS

FL Flush
DF Drywall flange

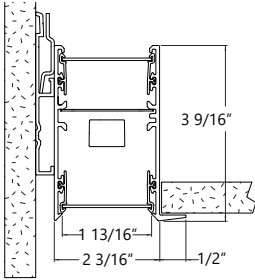

2RG 2" regressed
DF Drywall flange

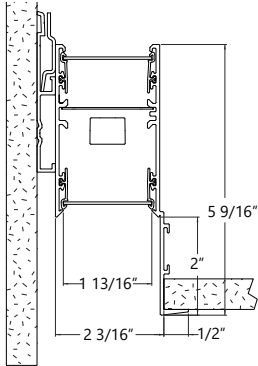

FL Flush
DS Drywall spackle

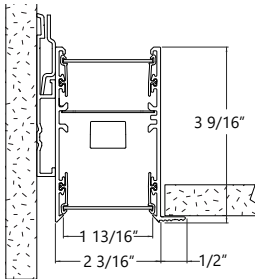

2RG 2" regressed
DS Drywall spackle

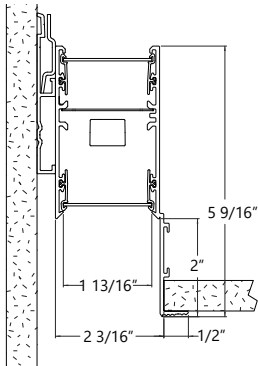

● PHOTOMETRIC DATA

SO Spotless lens - Down

1100 lm/ft

PHOTOMETRIC CURVE

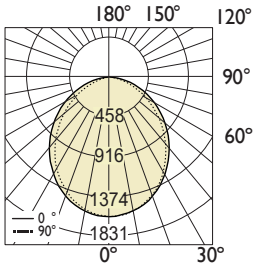

| CANDELA DISTRIBUTION | | | | | |
|----------------------|-------------------|------|------|------|------|
| Vertical Angle | Horizontal Angles | | | | |
| | 0 | 22.5 | 45 | 67.5 | 90 |
| 0 | 1830 | 1830 | 1830 | 1830 | 1830 |
| 5 | 1824 | 1817 | 1816 | 1809 | 1811 |
| 15 | 1739 | 1728 | 1720 | 1704 | 1704 |
| 25 | 1582 | 1557 | 1536 | 1515 | 1507 |
| 35 | 1355 | 1330 | 1304 | 1264 | 1254 |
| 45 | 1101 | 1073 | 1038 | 977 | 956 |
| 55 | 830 | 802 | 741 | 674 | 660 |
| 65 | 552 | 518 | 454 | 395 | 380 |
| 75 | 288 | 243 | 193 | 151 | 143 |
| 85 | 71 | 38 | 19 | 14 | 14 |
| 90 | 5 | 5 | 4 | 4 | 4 |

| ZONAL LUMENS | |
|--------------|--------|
| Zone | Lumens |
| 0 | |
| 0-10 | 172 |
| 10-20 | 486 |
| 20-30 | 712 |
| 30-40 | 819 |
| 40-50 | 802 |
| 50-60 | 673 |
| 60-70 | 466 |
| 70-80 | 227 |
| 80-90 | 44 |
| 90 | |

| LUMINANCE DATA (cd/m ²) | | | |
|-------------------------------------|-------------------|-------|-------|
| Vertical Angle | Horizontal Angles | | |
| | 0 | 45 | 90 |
| 45 | 25408 | 23959 | 22065 |
| 55 | 23612 | 21072 | 18775 |
| 65 | 21313 | 17524 | 14662 |
| 75 | 18139 | 12140 | 9006 |
| 85 | 13344 | 3503 | 2604 |

Total Lumens: 4401 lm (for 4ft)
Input Watts: 39.4 W
Efficacy: 112 lm/W

IES FILE: SK2R-FF-4'-1100-90-35-SO.ies

TESTED ACCORDING TO IES LM-79-2019

i All IES files are available for download at: www.axislighting.com

IMPORTANT – all patterns must be submitted with drawings indicating size and radii dimensions.

