



Project _____

Type _____

Notes _____

PERFORMANCE PER LINEAR FOOT AT 4000K

NOMINAL LUMEN OUTPUT	INPUT WATTS*	EFFICACY	SHIELDING
1200 lm/ft	9.4 W/ft	128 lm/W	SO
1200 lm/ft	10 W/ft	119 lm/W	UB

* Based on a 4 foot luminaire using one driver
Please consult factory for custom lumen output and wattage.

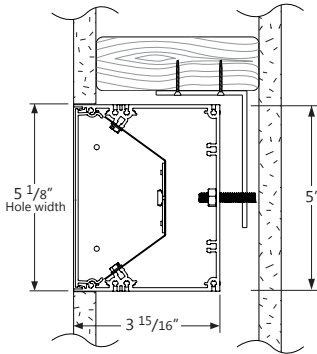

Ordering Guide

B6RVLED											
PRODUCT ID		NOM. LUMENS/FT		CRI		COLOR TEMP. (choose one)		SHIELDING			
B6RVLED	Recessed Vertical LED	400	400 lm/ft - Minimum	80	80 CRI	27	2700 K	TW2750	2700-5000 K - Tunable White	SO	spotless lens
		1200	1200 lm/ft - Maximum	90	90 CRI*	30	3000 K	TW2765	2700-6500 K - Tunable White	UB	Ultra blend lens*
						35	3500 K	BTW3527	3500-2700 K - Tunable BIOS		
						40	4000 K	BTW4027	4000-2700 K - Tunable BIOS		
						B30	3000 K - BIOS*				
						B35	3500 K - BIOS*				
						B40	4000 K - BIOS*				
		Outputs between listed min and max are available. Consult factory for outputs outside of the listed range. Consult factory for max output with BIOS		* Not available with BIOS.		Consult Axitone technical sheet for more information of color technology. *Consult BIOS guide for more information on BIOS technology				* Default lens for Tunable white and BIOS. Consult factory for other lens.	

LENGTH	FINISH	VOLTAGE	DRIVER	CIRCUITS	MOUNTING/SUSPENSION
2 2'	W white	120 120 V	DP dimming (0-10V) 1%	1 1 circuit	DF drywall flange
3 3'	C custom	277 277 V	LT(#) Lutron*	2 2 circuits	DS drywall spackle flange
4 4'		347 347 V	BI bi-level dimming	+E(#) emergency circuit*	D drywall flangeless
5 5'		UNV universal	O(#) other**	+NL(#) night light circuit*	
6 6'		DC low voltage*	DPB(STC) dimming (0-10V) 1% with BIOS*	+GTD(#) generator transfer device*	
8 8'			DPB(DYN) Bio-dimming™ 100%-81% with BIOS*		
12 12'			TW(#) tunable white drivers*		
S# system run			POE(#) POE drivers*		
		* Only available with POE drivers.	*See page 2 to specify system **Please consult factory; see page 2	*Specify quantity	

BATTERY (OPTIONAL)	OTHER (OPTIONAL)	CUSTOM (OPTIONAL)
B(#) battery pack 4' sections	EF end feed FW flex whip (6' std)*	C custom
Not available with 347V. Please consult factory.	* Other lengths available; please consult factory.	Please specify

● SPECIFICATIONS

CONSTRUCTION

Housing	Extruded aluminum (0.075" nominal) Up to 70% recycled content
Interior Brackets	Die formed sheet steel (18 gauge)
Reflectors	White powder coated sheet steel (22 gauge)
Blank	Extruded aluminum (0.075" nominal)
Lens	Spotless frosted acrylic lens

● ELECTRICAL

Lutron driver	LDE1 - Hi-lume 1% EcoSystem with Soft-on, Fade-to-Black
Other drivers**	DALI - Digital Addressable Lighting Interface DMX - Digital Multiplex Xitanium SR - For wireless sensor
BIOS DPB drivers*	STC - BIOS control 0-10V with static spectrum and BIOS SkyBlue enabled from 100% to 1%. DYN - BIOS control 0-10V with dynamic spectrum and BIOS SkyBlue® with Bio-Dimming™, which changes spectral qualities by removing the SkyBlue component when dimming from 100% to 81%, while light output remains relatively constant; bio-dimming reduces CCT to 2700K. Dimming from 80% to 1% will then reduce light output.
Tunable White TW drivers*	DALIDT6 - DALI Type 6 (Two DALI Addresses) DALIDT8 - DALI Type 8 (One DALI Address) DPTW - two channel 0-10V dimming: one channel for brightness, one channel for CCT. LDTW - Lutron DALI Type 8 (One DALI address) Tunable White series
Power over Ethernet POE drivers*	MOLEX IGOR UL2108 certified for integral or remote driver SMARTENGINE O - Other (Consult factory)
Emergency	Integral emergency battery pack or emergency circuit optional.
Input Voltage	120V, 277V, 347V, UNV, DC.
Flex Whip	Shipped in a separate box for contractors to install

*Choose driver from available options.

i Incorporating these components may have limitations or affect the length of the luminaire. Please contact factory for more details.

● SYSTEM (S#)

BEAM6 LED linear systems, with the use of a strong profile, allow for a nearly hair thin connection system of continuous runs. Lengths of 4', 8', 12' as well as custom lengths are available. Runs of BEAM6 LED that are greater than 12ft in length are designated as systems (S#). This means that the run is comprised of a combination of 4', 8' and/or 12' sections to be assembled on site using our joining system. For more information on systems and joining, please refer to the BEAM6 LED installation sheets available for download at www.axislighting.com.

● LED SYSTEM

CRI	Minimum 80 or 90 color rendering index.
CRI BIOS	Minimum 80 color rendering index with R9>75 for all CCTs.
CCT Single Color	Choice of 2700K, 3000K, 3500K and 4000K color temperature with a great color consistency (within 3-step MacAdam ellipse). Both within fixture and fixture to fixture.
CCT BIOS	BIOS Static (STC) Choice of 3000K, 3500K and 4000K. BIOS SkyBlue® Dynamic (DYN) Choice of 3000K, 3500K, and 4000K with Bio-Dimming™ BIOS Tunable White (BTW) Choice of 4000-2700K and 3500-2700K; does not use a bio-dimmer, it uses TW drivers, which allow independent control of CCT and intensity; e.g., BTW4027 provides combined SkyBlue + white light at 4000K, SkyBlue is removed at 2700K. Light output can be adjusted for each CCT. Consult BIOS guide for more information on BIOS technology.
CCT Axitune Systems	Consult Axitune technical sheet for more information on color technology.
LED life	Minimum 50,000h with 85% of lumen maintenance in 25°C ambient temperature, in compliance with IES LM-80 testing measurements.
Thermal Management	Aluminum housing acting as the heat sink to maximize life.
Environment	Dry and damp rated for indoor use only in operating ambient temperatures of 0-40°C (32-104°F).

● OPTICS

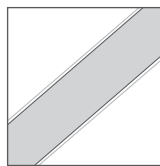

SO spotless lens
UB Ultra Blend Lens

SPOTLESS LENS

Frosted acrylic snap-in lens with micro lens

ULTRA BLEND LENS

Frosted acrylic snap-in micro lens suitable for Tunable White and BIOS applications.

● WEIGHT

Recessed Vertical 4 ft	16.3 lbs / 7.4 kg
Recessed Vertical 8 ft	32.6 lbs / 14.8 Kg
Recessed Vertical 12 ft	48.9 lbs / 22.2 Kg

● FINISH

Powder coated and custom finishes are also available.

● VERTICAL RECESSED MOUNTING OPTIONS

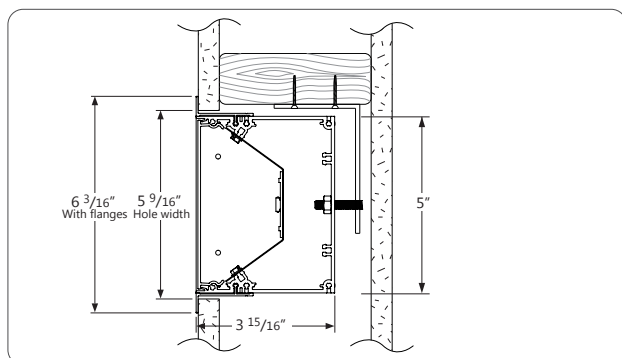

DF DRYWALL FLANGED

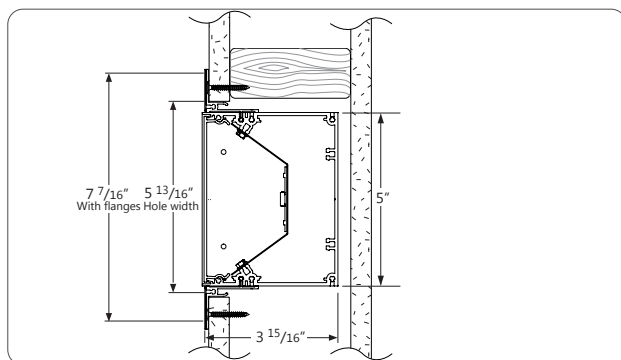

DS DRYWALL SPACKLE FLANGE

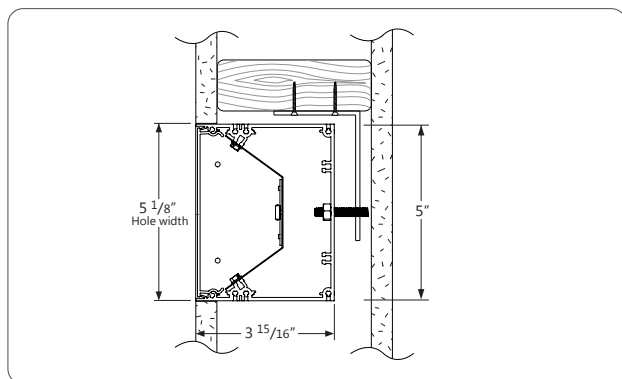

D DRYWALL SPACKLE FLANGE

● APPROVALS

Certified to UL and CSA standards
Meets NYC requirements
Suitable for damp locations
IC Rated (Insulated ceiling)



● WARRANTY

Limited 5-year warranty is available. Warranty is valid provided luminaires are installed and used according to specifications. For full terms and conditions, please consult warranty section at axislighting.com.

● CORNERS

Unlit Corners - BEAM6 LED features a multitude of layout patterns with the use of a number of corners, 90° corner, T or X junctions.

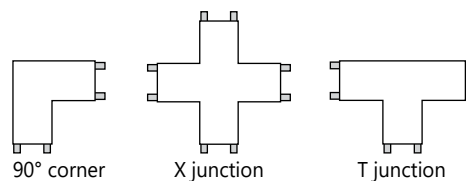
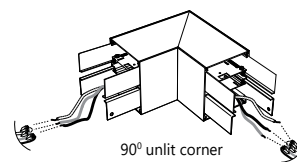

Lit Corners - Axis also offers Lit 90° corners including ceiling to ceiling, wall to ceiling and ceiling to wall.

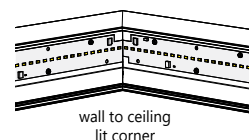

i For custom corner angles, please consult factory. Specifications sheets for all corners are available at: www.axislighting.com

● JOINERS

In order to allow very long runs of BEAM6 LED luminaires, Axis has developed an effective joining system. Special care has been taken to maximize the performance of the joiner for each BEAM6 LED option.

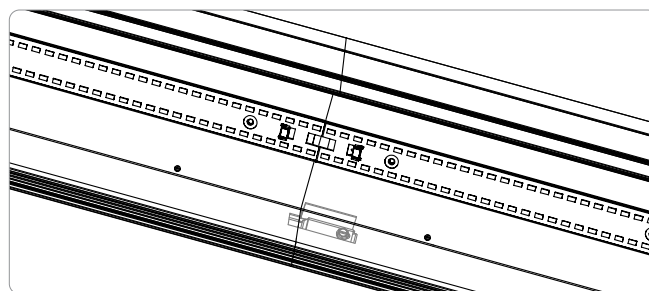
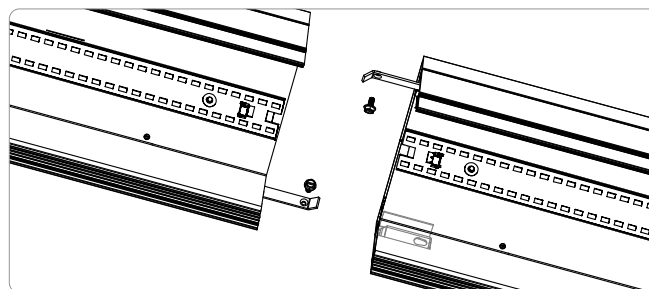

JOINER SYSTEM

NOTE: Hang each system segment individually. Do not assemble system prior to hanging.

● OTHER MOUNTING OPTIONS

BEAM6 LED is also available with recessed, pendant, surface and wall mounted options.

i Specification sheets and installation sheets for all mountings for BEAM6 LED luminaires are available for download at www.axislighting.com

● PHOTOMETRIC DATA

SO Spotless lens

1200 lm/ft

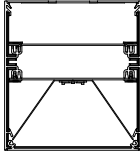

PHOTOMETRIC CURVE

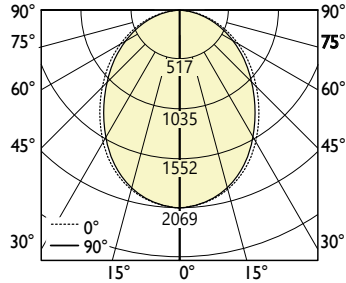

Lumen/ft: 1200 lm/ft
Total Lumens: 4801 lm (for 4ft)
Input Watts: 37.4 W
Efficacy: 128 lm/W

IES FILE: B6RVLED-1200-80-35-FL-4.IES

TESTED ACCORDING TO IES LM-79-2008

CANDELA DISTRIBUTION

Vertical Angle	Horizontal Angles				
	0	22.5	45	67.5	90
0	2069	2069	2069	2069	2069
5	2054	2052	2049	2048	2048
15	1943	1933	1920	1909	1906
25	1738	1719	1692	1666	1656
35	1458	1436	1397	1358	1342
45	1142	1121	1078	1034	1017
55	825	807	768	728	713
65	527	515	487	460	449
75	272	266	255	242	237
85	76	74	71	68	67
90	4	4	4	3	3

ZONAL LUMENS

Zone	Lumens
0	
0-10	195
10-20	544
20-30	786
30-40	883
40-50	842
50-60	697
60-70	492
70-80	276
80-90	85
90	

LUMINANCE DATA (cd/m²)

Vertical Angle	Horizontal Angles		
	0	45	90
45	10504	9913	9356
55	9357	8704	8087
65	8117	7497	6905
75	6831	6399	5945
85	5645	5324	4990

UB Ultra blend lens

1200 lm/ft

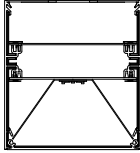

PHOTOMETRIC CURVE

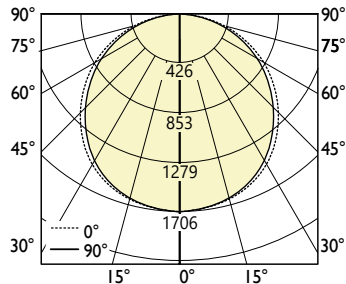

Lumen/ft: 1200 lm/ft
Total Lumens: 4800 lm (for 4ft)
Input Watts: 40.3 W
Efficacy: 119 lm/W

IES FILE: B6RVLED-1200-80-35-UB-4.IES

TESTED ACCORDING TO IES LM-79-2008

CANDELA DISTRIBUTION

Vertical Angle	Horizontal Angles				
	0	22.5	45	67.5	90
0	1705	1705	1705	1705	1705
5	1695	1696	1698	1701	1702
15	1625	1631	1639	1646	1647
25	1495	1504	1519	1524	1529
35	1313	1326	1344	1349	1356
45	1099	1110	1131	1129	1134
55	836	868	882	882	886
65	575	606	620	623	626
75	325	343	363	367	373
85	102	114	133	143	144
90	3	13	27	37	39

ZONAL LUMENS

Zone	Lumens
0	
0-10	161
10-20	459
20-30	691
30-40	826
40-50	848
50-60	760
60-70	584
70-80	353
80-90	118
90	

LUMINANCE DATA (cd/m²)

Vertical Angle	Horizontal Angles		
	0	45	90
45	10126	10414	10441
55	9494	10019	10064
65	8857	9556	9644
75	8190	9142	9391
85	7647	9928	10753

i All IES files for other lamping are available for download at: www.axislighting.com